



DAMEN CRANE BARGE 8025

"IB 429"

GENERAL

YARD NUMBER	522054
DELIVERY DATE	July 2013
BASIC FUNCTIONS	Harbor construction
CLASSIFICATION	ABS Marine: +A1 Barge, UWILD, CRC
FLAG	NL
OWNER	BAM International

DIMENSIONS AND CAPACITIES

LENGTH O.A.	80.25 m
BEAM O.A.	25.00 m
DEPTH AT SIDES	4.50 m
DRAUGHT DESIGN	3.15 m
DEADWEIGHT	4600 ton
DECK AREA	1600 m ²
DECK STRENGTH	10 ton/m ²
DECK THICKNESS	14 mm
WATER BALLAST	3900 m ³

CRANE PERFORMANCE

MAKE	PLM
TYPE	6400
SWL	400 ton @ 16 m
MAIN BOOM	62 m

AUXILIARY EQUIPMENT

GENERATOR SET	2x Caterpillar C6.6
POWER	2x 136 ekW, 400 V, 50 Hz

DECK LAY-OUT

ANCHOR MOORING SYSTEM	DMT 6 point Electric mooring system, Aft winches are located below deck
ANCHORS	6 Flipper type anchors
TOWING BRACKETS	2 Towing brackets SWL 100 ton 1 Emergency Towing bracket

STANDARD EXECUTION

LOOSE BOARDING LADDERS	2 on SB and 2 on PS mounted with chains
CATHOLIC PROTECTION	Zinc anodes on underwater part of the hull
MANHOLES	Flush single point closing manholes
BILGE PUMP	Manual bilge pump
LIGHTING & VENTILATION	Lighting and ventilation in pump room

ACCOMMODATION

12 person day-accommodation with pantry, sanitary, change room, control room, First Aid room and 3 offices, provided with ventilation, air conditioning and heating.

NAUTICAL EQUIPMENT

Navigation lighting according Classification.

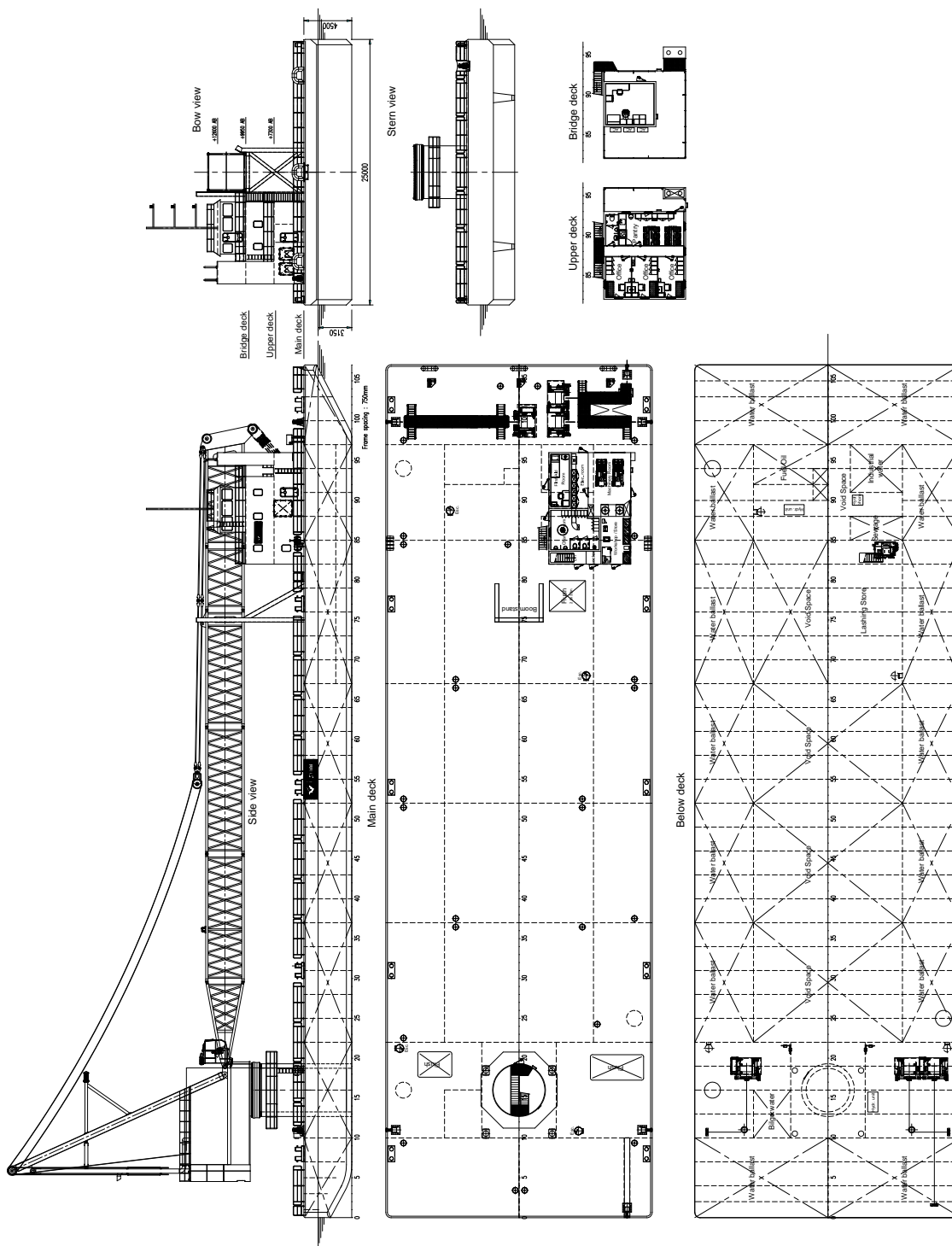

DAMEN CRANE BARGE 8025

"IB 429"

DAMEN

DAMEN SHIPYARDS GORINCHEM

Member of the DAMEN SHIPYARDS GROUP



Industrieterrein Avelingen West 20
4202 MS Gorinchem

P.O. Box 1
4200 AA Gorinchem
The Netherlands

phone +31 (0)183 63 99 11
fax +31 (0)183 63 21 89

info@damen.com
www.damen.com