



DAMEN MODULAR BOOSTER PONTOON 1810

"YN 523021"

GENERAL

Yard number	523021
Basic functions	The Damen Modular Booster Pontoon is a pontoon with booster and accommodation, built in steel to standard design.
Description	The entire hull of the Pontoon consists of container sized units. These container sized units are called Damen Modular Barges and can be coupled together in the water with a specially designed coupling system, called the Damen Link. Because of this modular system, the entire Pontoon can be transported by ship, truck or train to her final place of destination and assembled locally.
Classification	Lloyd's register

DIMENSIONS

Length o.a.	18.00 m
Beam o.a.	10.00 m
Depth at sides	1.80 m
Draught (empty)	0.80 m

CAPACITIES

Fuel oil	2x 25 m ³
Fresh water	8.00 m ³
Waste water	8.00 m ³
Daytank main engine	1.00 m ³
Daytank generator set	0.35 m ³
Max. deck load	6.80 t/m ²

DREDGE INSTALLATION

Dredge pump	BP 7570
Impeller diameter	1720 mm
Suction pipe diameter	750 mm
Discharge pipe	750 mm
Booster capacity	8500 m ³ /h

ENGINE INSTALLATION

Main engine	Caterpillar 3516 TA, HD radiator and water cooled
Constant power	1825 kW at 1600 rpm
Gearbox	Kreiskott

ELECTRICAL SYSTEM

Capacity generator set	35 kVA
------------------------	--------

DECK LAY-OUT

Capacity anchor winches	3 kW
Anchor	4x 500 kg

SUPERSTRUCTURE

Galley container with hydrophore pump	1x
Bedroom/bathroom container	1x

Side view

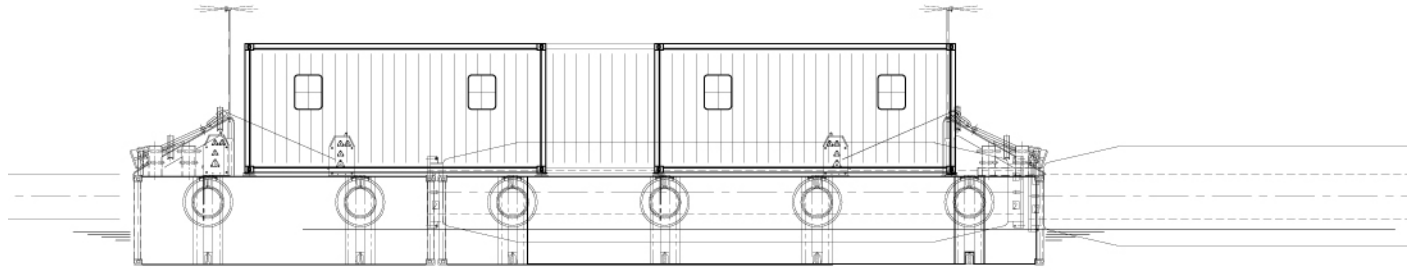

METERS 0 5 10 15 20 25

Top view

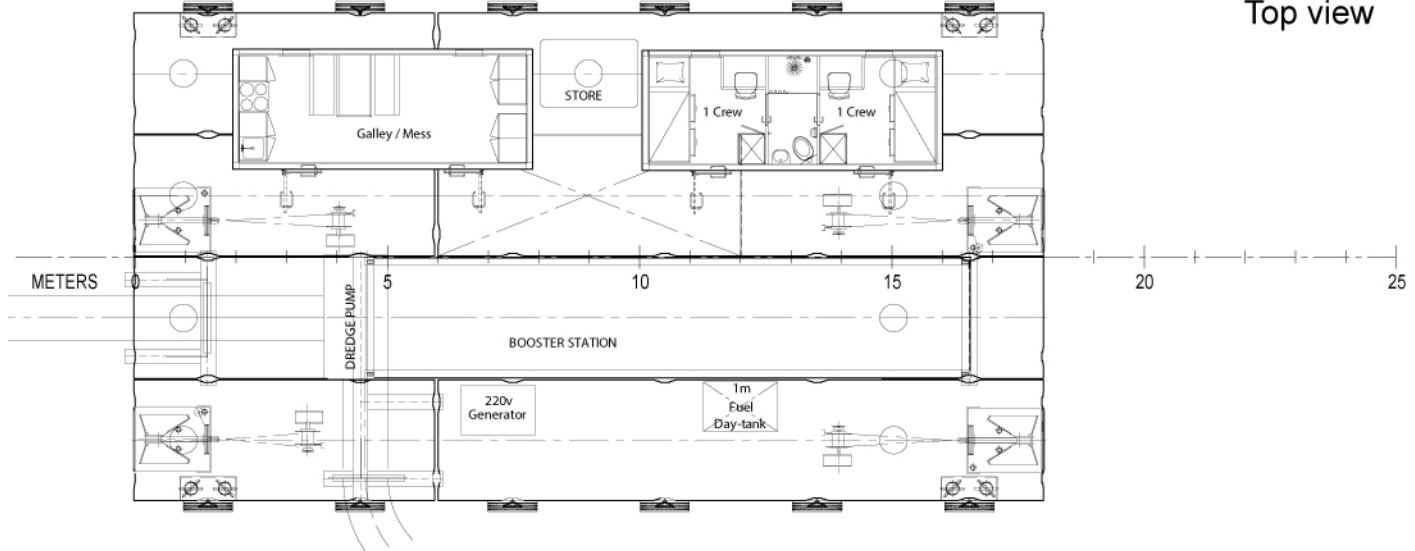

METERS 0 5 10 15 20 25

Main deck

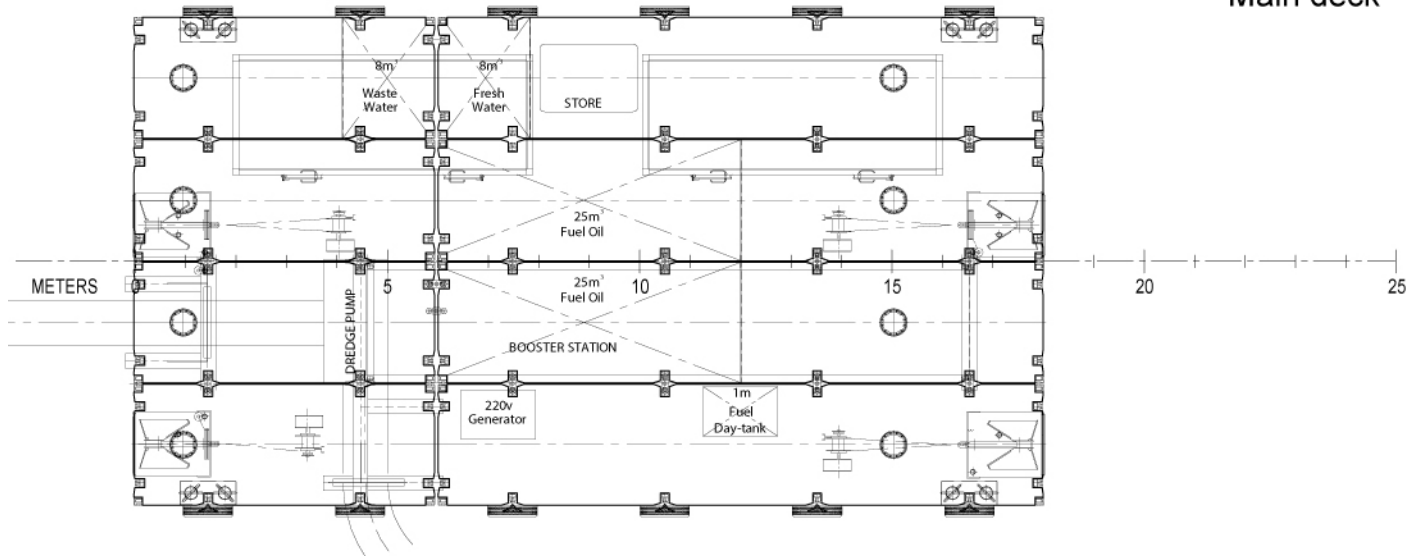

METERS 0 5 10 15 20 25

DAMEN MODULAR BOOSTER PONTOON 1810

"YN 523021"



DAMEN SHIPYARDS GORINCHEM

Member of the DAMEN SHIPYARDS GROUP 

Industrieterrein Avelingen West 20
4202 MS Gorinchem

P.O. Box 1
4200 AA Gorinchem
The Netherlands

phone +31 (0)183 63 99 11
fax +31 (0)183 63 21 89

info@damen.com
www.damen.com