



DAMEN UV 2510

GENERAL

PROJECT NUMBER
FUNCTIONS

STD
Fish farm support, buoy laying,
maintenance support, Dive and ROV
support.

CLASSIFICATION

Lloyd's register or equivalent
☒100A1 [☒] LMC, UMS

DIMENSIONS

LENGTH O.A.
BEAM MLD.
DEPTH
DRAUGHT DESIGN
DEADWEIGHT
WORK DECK AREA
DECK LOAD (1M ABOVE DECK)

25.7 m
10.0 m
3.5 m
2.6 m
150 ton
120 m²
90 t

TANK CAPACITIES

FUEL OIL
FRESH WATER
SEWAGE
BILGEWATER
BALLAST WATER
CARGO HOLD

30.0 m³
15.0 m³
5.5 m³
2.0 m³
TBD m³
80 m³

PERFORMANCES (APPROX.)

SPEED (AT DESIGN DRAUGHT)
BOLLARD PULL

9.5 kn
13.4 ton

PROPULSION SYSTEM

MAIN ENGINES
TOTAL PROPULSION POWER
GEARBOXES
PROPELLERS
BOW THRUSTER
RUDDERS

2x Volvo D13 MH
736 kW (1000 bhp) @ 1800 rpm
2x Reverse reduction, ratio 4.5:1
2x 1350 mm FPP in nozzle
1x 100 kW, FPP, Electric
2x fishtail rudders, interconnected

AUXILIARY EQUIPMENT

NETWORKS
GENERATOR SETS
COOLING SYSTEM
HYDRAULIC SYSTEM

230/440 V @ 60 Hz, 230 V @ 50 Hz
2x Volvo D9 MG, 312 kVA
Fresh water through box cooling
Each crane has a dedicated HPU electric
driven.

DECK LAY-OUT

ANCHORS
ANCHOR MOORING WINCH
CAPSTANS
DECK CRANE AFT

1x High Holding Power
1x with 165 m anchor rope, electric
2x 5 ton, electrically driven
1x Foldable knuckle boom 1.1 ton @ 18.55
m fitted

DECK CRANE FORWARD

1x Foldable knuckle boom 0.93 ton @
15.01 m fitted

STERN ROLLER

500 mm diameter

ACCOMMODATION

A ventilated and heated accommodation for 6 persons is fitted. The accommodation includes 4 cabins, a wheelhouse, galley, mess room, deck office and a drying locker. The large wheelhouse offers a seating area, chart table and navigation consoles.

NAUTICAL AND COMMUNICATION EQUIPMENT

EXTERNAL COMMUNICATION
INTERNAL COMMUNICATION
NAUTICAL SYSTEMS

2x VHF, SSB, Navtex, AIS
Intercom
X-band radar, ECS, DGPS, echo-sounder

TOWING OPTIONS

TOWING WINCH

15 ton @ 15 m/min pull and 45 ton
brake on first layer. Drum capacity 500
m x 32 mm diameter.
SWL 25 ton

TOWING PINS

BUOYLAYING OPTIONS

BUOY CHAIN CLAMP
HOLD

1x manual operated buoy chain clamp
Fish tank to be executed as buoy
chain locker, fir-wood flooring

OTHER OPTIONS

DECK CRANES
POSITIONING PACKAGE

Alternative cranes are possible
DP-0 or DP-1

All data presented is preliminary and is subject to change without prior notice. Artist impression and general arrangement plan show optional equipment for aqua culture support. Options may impact performances. Other options are available upon request.

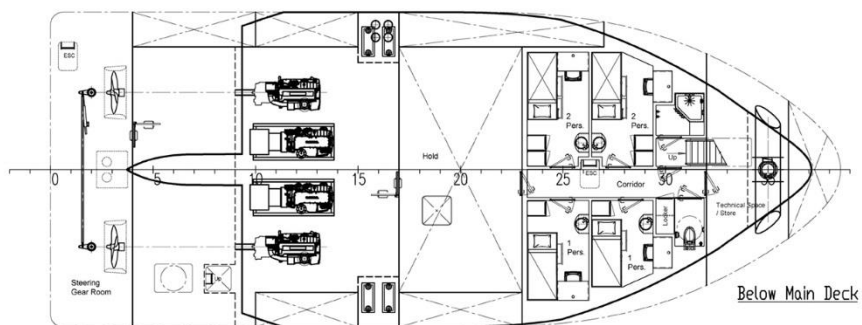
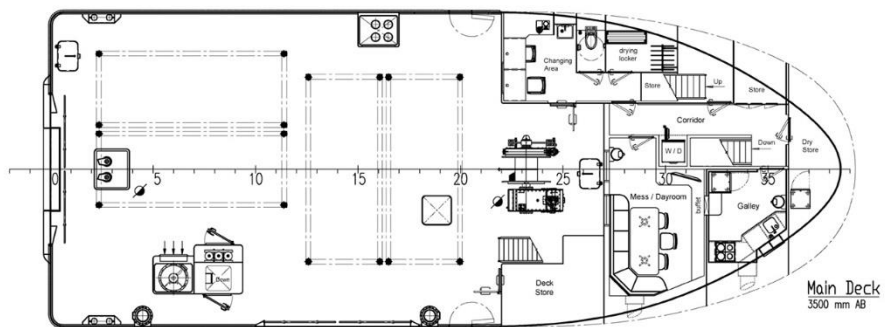
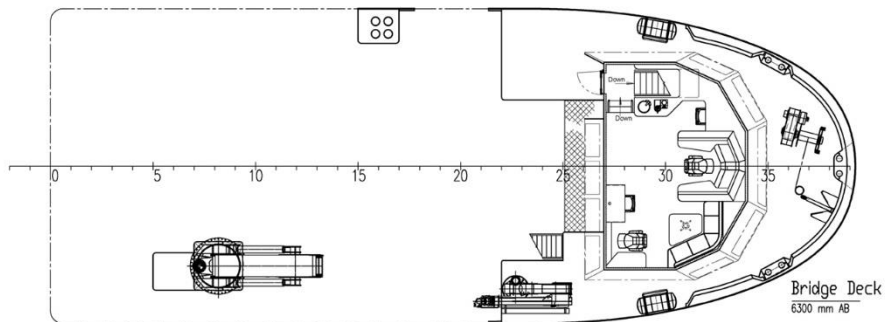
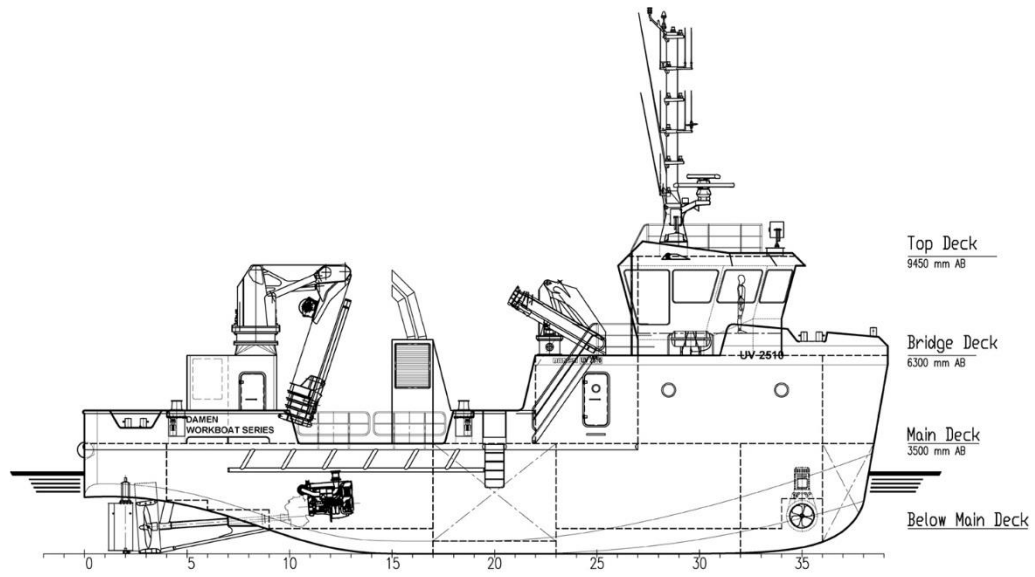

DAMEN UV 2510

DAMEN

DAMEN SHIPYARDS GORINCHEM

Member of the DAMEN SHIPYARDS GROUP 

Industrieterrein Avelingen West 20
4202 MS Gorinchem

P.O. Box 1
4200 AA Gorinchem

phone +31 (0)183 63 99 11
fax +31 (0)183 63 21 89

info@damen.nl
www.damen.nl The Netherlands

Registered at the Chamber of Commerce, no. 23036357, under the name BV Scheepswerf Damen Gorinchem.

All our offers are without engagement unless stated otherwise.

All activities carried out in accordance with the VNSI General Yard Conditions (Netherlands Shipbuilding Industry Association).