



STAN TENDER 2306

STANDARD

GENERAL

Hull material	Steel
Superstructure	Aluminium
Basic functions	Pilot, survey, crew boat and patrol duties

DIMENSIONS

Length overall	23.5 m
Beam overall	6.0 m
Depth at side	3.1 m
Draught max	2.0 m
Crew	Up to 6 persons
(Industrial) personnel	Up to 24 persons

TANK CAPACITIES

Fuel oil	13.0 m ³
Fresh water	2.4 m ³
Sewage	0.7 m ³
Bilge water/ dirty oil	0.5 m ³

PERFORMANCES

Speed	Up to 26.0 kn
Range at max speed	435-560 nm

PROPULSION SYSTEM

Main engines	2x Caterpillar/MTU
Total Power	Up to 2500 bkW
Gearboxes	2x Reintjes WVS series
Propulsion	2x fixed pitch propellers

ELECTRICAL EQUIPMENT

Network	24 V dc, 230V, 50 Hz a.c.
Generator sets	1x 38.0 kW, 47.5 kVA

DECK LAY-OUT

Anchor equipment	1x Fortress, chain and line
Fendering	Rubber "D" type, 235 nm
MOB recovery system	Electrically operated elevating platform

SHIP SYSTEMS

General service pump	1x electrically driven
Engine room ventilation	2x 20.000 m ³ /hr
Fire extinguishing	Hand operated fire extinguishers. Fixed fire-fighting system in engine room (Novec 1230)

ACCOMMODATION

Main deck	Seats for personnel
Below main deck	Cabins, settee, galley and sanitary space
Air conditioning	Up to 90.000 BTU/hr

NAUTICAL AND COMMUNICATION EQUIPMENT

Searchlight	1x
Radar	1x
Chart plotter	1x
GPS	1x
AIS	1x
Compass	1x Magnetic
Echo sounder	1x
VHF	1x

OPTIONAL

Classification	Bureau Veritas I ✕Hull • MACH Light Ship/ Fast Utility Vessel Sea Area 2
Second radar	
Autopilot	
External communication	GMDSS A1/A2
Weather system	

STAN TENDER 2306

STANDARD

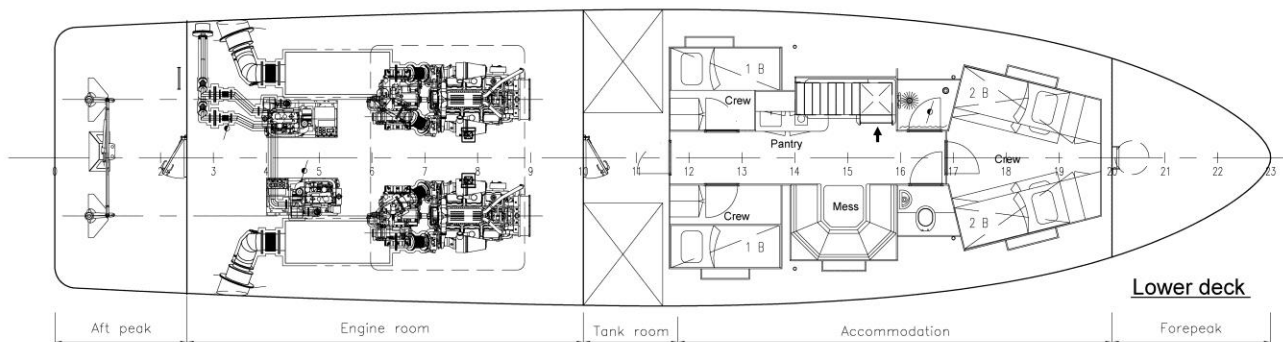
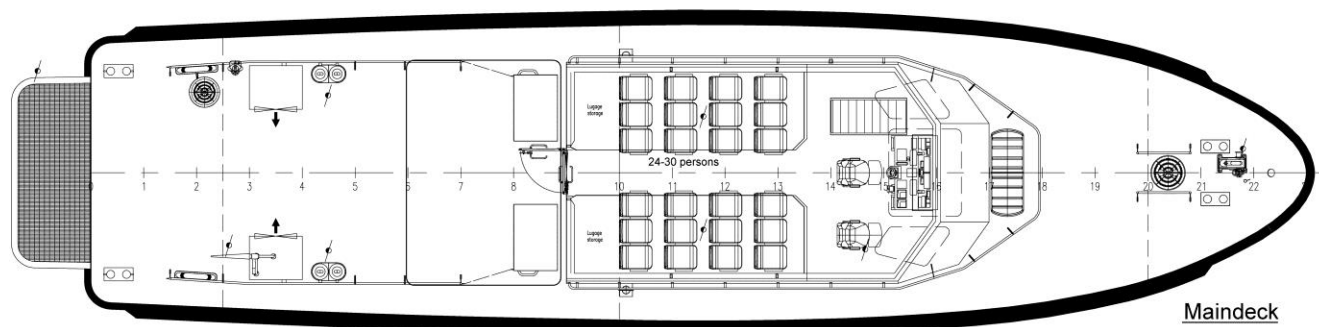
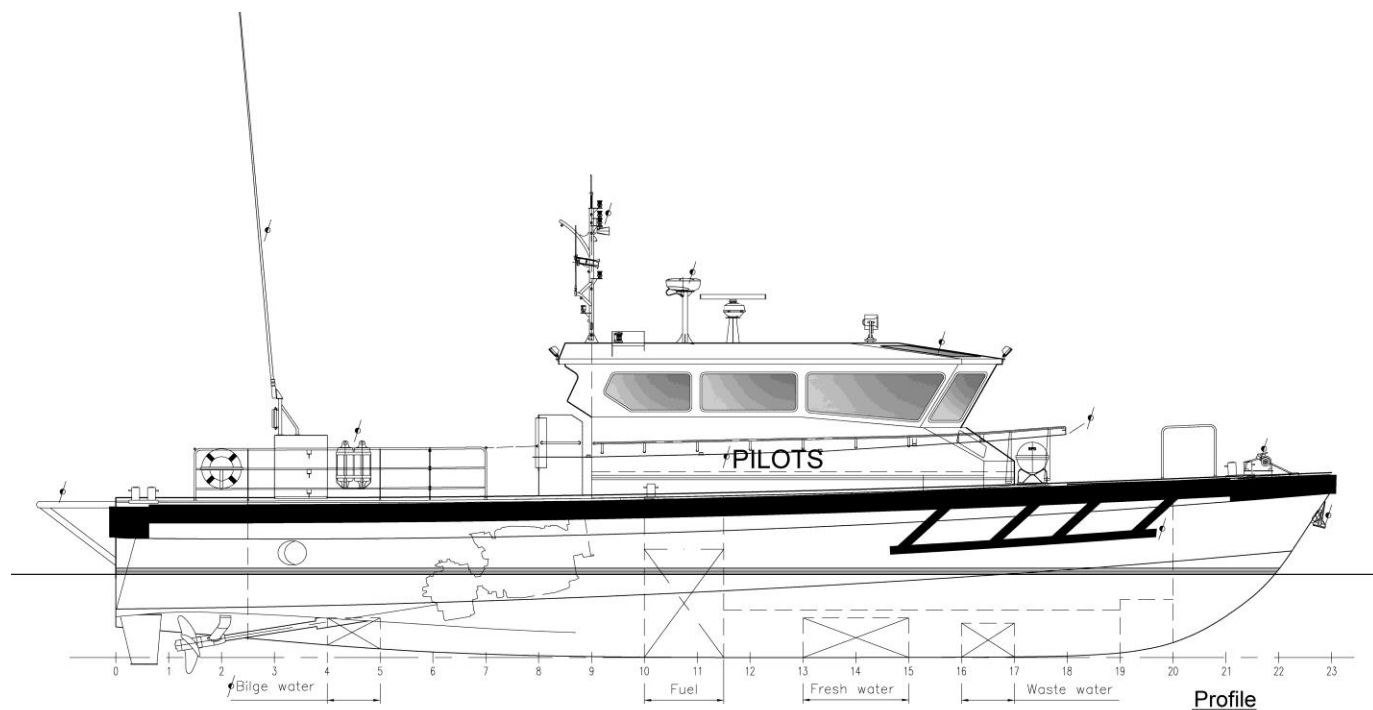

DAMEN

Items marked with  are optional equipment

DAMEN SHIPYARDS GROUP

Avelingen-West 20
4202 MS Gorinchem
The Netherlands

P.O. Box 1
4200 AA Gorinchem
The Netherlands

phone +31 (0)183 63 99 22
fax +31 (0)183 63 21 89

info@damen.com
www.damen.com

© No part of the leaflet may be reproduced in any form, by print, photo print, microfilm, or any other means, without written permission from Damen Shipyards Group