



STAN PATROL 3007

STANDARD

GENERAL

Hull material	Aluminium
Superstructure	Aluminium
Basic functions	Patrol duties, maritime safety, securing economical waters, search and rescue
Classification	Bureau Veritas I ✱ Hull • MACH Light Ship / Fast Patrol Boat Sea Area 3

DIMENSIONS

Length overall	30.5 m
Beam overall	7.1 m
Depth at side	2.6 m
Draught max	2.2 m
Crew	Up to 12 persons

TANK CAPACITIES

Fuel oil	15.9 m ³
Fresh water	3.4 m ³
Sewage	4.1 m ³
Bilge water/ dirty oil	1.1 m ³

PERFORMANCES

Speed	Up to 30.0 kn
Range at max speed	680 nm

PROPULSION SYSTEM

Main engines	2x Caterpillar / MTU
Total Power	Up to 3260 bkW
Gearboxes	2x Reintjes
Propulsion	2x fixed pitch propellers
Bow thruster	1x 50 kW

ELECTRICAL EQUIPMENT

Network	24V dc, 230V/400V 50 Hz a.c.
Generator sets	1x 58.5 ekW – 73.0 kVA

DECK LAY-OUT

Anchor equipment	1x HPP Pool TW, chain and line
Anchor winch	1x electrically driven
Slipway	

SHIP SYSTEMS

General service pump	2x electrically driven
Fuel separator	1x dynamic
Engine room ventilation	2x 13.000 m ³ /hr
Fire extinguishing	Hand operated fire extinguishers. Fixed fire-fighting system in engine room (Aerosol)

ACCOMMODATION

Main deck	Cabins, store, sanitary spaces, galley and mess
Below main deck	Cabins, sanitary spaces and store
Air conditioning	Up to 165.000 BTU/hr

NAUTICAL AND COMMUNICATION EQUIPMENT

Searchlight	1x
Radar	1x
GPS	1x
Compass	1x Magnetic
Heading sensor	1x
Echo sounder	1x
CCTV system/loudhailer	1x
External communication	GMDSS A1
Weather system	1x

OPTIONAL

Fresh water maker	
Sewage treatment plant	
Daughter craft for slipway	
Stabilizers	
Second searchlight	
Second radar	
Chart plotter/ECDIS	
AIS	
Autopilot	
Night vision camera	
External communication	GMDSS A2/A3
Fleet broadband	
Military equipment/ballistic protection	

STAN PATROL 3007

STANDARD

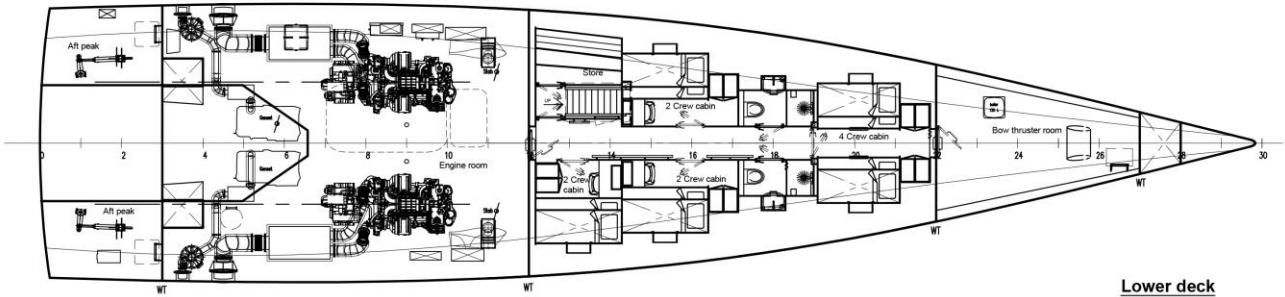
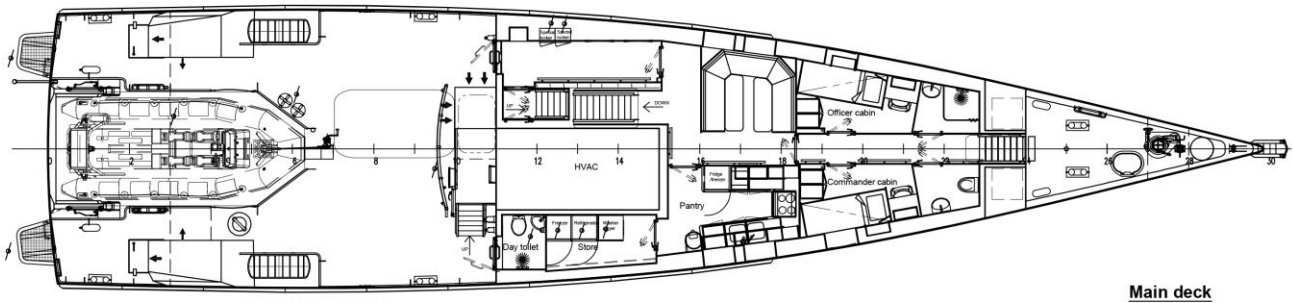
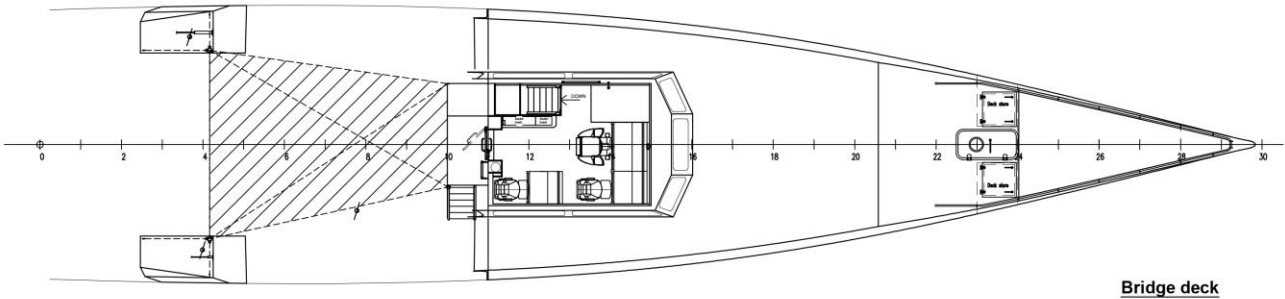
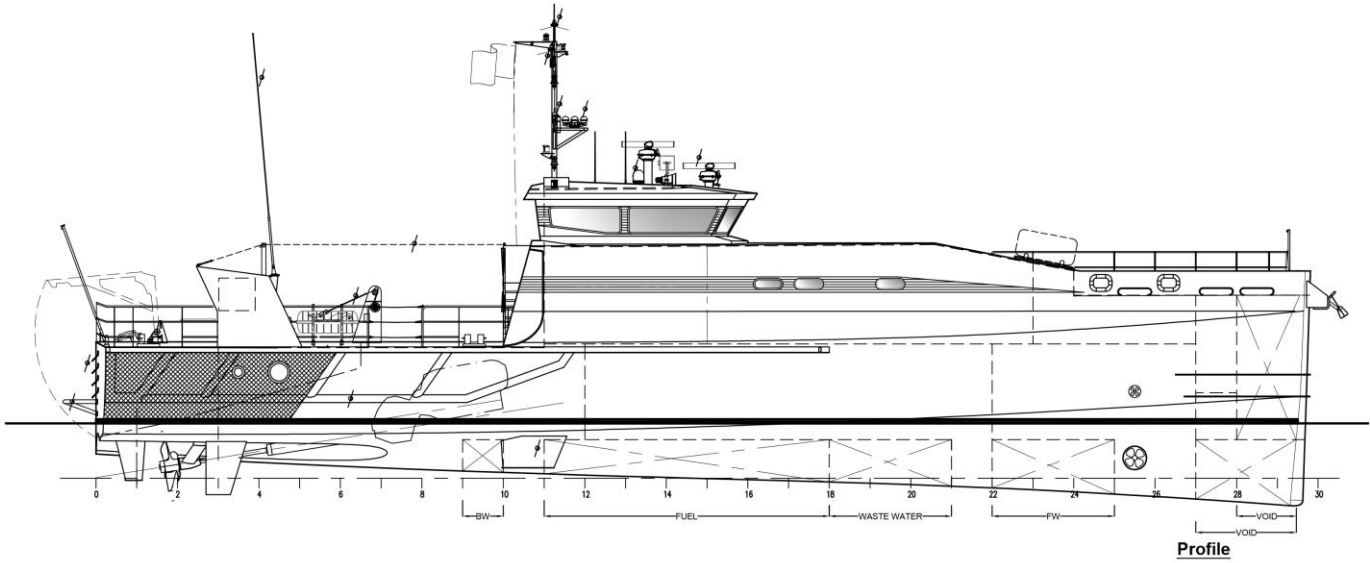

Items marked with  are optional equipment

DAMEN SHIPYARDS GROUP

Avelingen-West 20
4202 MS Gorinchem
The Netherlands

P.O. Box 1
4200 AA Gorinchem
The Netherlands

phone +31 (0)183 63 99 22
fax +31 (0)183 63 21 89

info@damen.com
www.damen.com

© No part of the leaflet may be reproduced in any form, by print, photo print, microfilm, or any other means, without written permission from Damen Shipyards Group